

STEPS REQUIRED FOR OPERATION:

1. Watering Start Times
2. Days To Water
3. Station Run Times

To verify: turn dial to Test All Stations / Check System, select Confirm Programs and review the Program Summary.

Programming Questions?
 Call 1-800-RAINBIRD
www.rainbird.com/ESPLXME

Basic Programming

1 Set Language

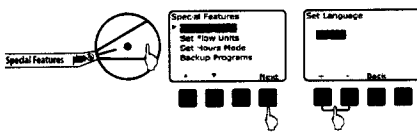

2 Set Current Date

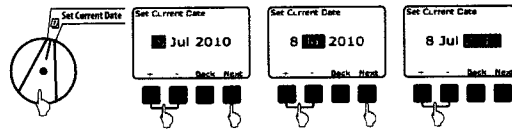

3 Set Current Time

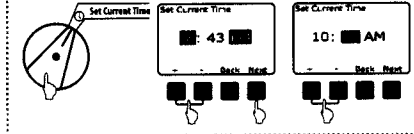

4 Set Watering Start Times

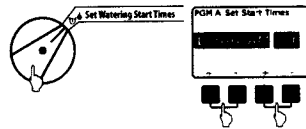

5 Set Days To Water - Custom Cycle

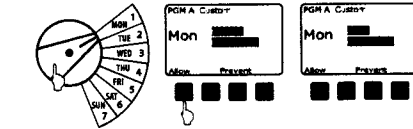

OR Watering Day Cycles

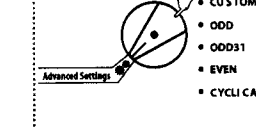

6 Set Station Run Times

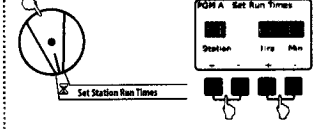

Manual Watering Options

Manual Watering Start Program

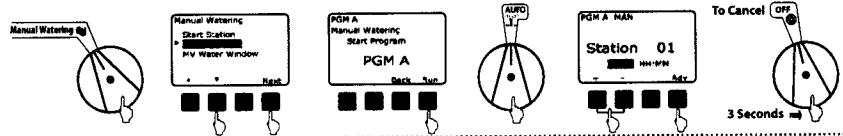

Manual Watering Start Station

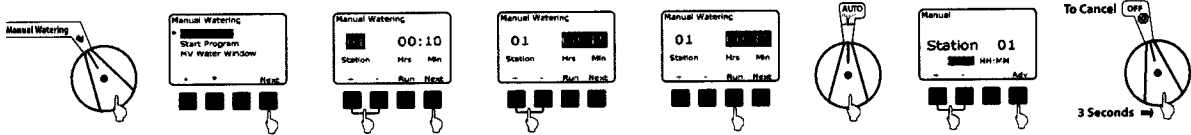

Troubleshooting

Test All Stations / Check System

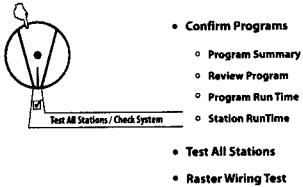

Alerts user to conditions that prevent watering. See the Alarm button in the Auto dial position for alarm messages.

Alarm Message	Action
Station Short	Run Raster Test - turn dial to Test All Stations.
No Modules or No Base Module	Check / reinsert modules.
Flow Alarm (only if optional Flow Smart Module is installed)	Turn dial to View Flow Alarms and select to View Flow Alarms.

Station and Base Module LED	
Flashing (red)	Module not recognized - reinstall. Station Short - run Raster Test.
Solid (red)	Recognizing module properly. Programming a station. Station is currently running.
LED not lit (dark)	No controller power. No station activity - check Run Time, Start Time and/or Days to Water. Module not recognized - reinstall.

Optional Flow Smart Module LED	
Flashing (blue)	Active flow being monitored by flow sensor.

